

Welcome

We extend a special welcome to those who are single, married, divorced, gay, filthy rich, dirt poor, y no habla ingles. We extend a special welcome to those who are crying newborns, skinny as a rail, or could afford to lose a few pounds. We welcome you if you sing like Andrea Bocelli or can't carry a note in a bucket. You're welcome here if you're just browsing, just woke up, or just got out of jail. We don't care if you're more Catholic than the Pope, or haven't been in church since little Joey's baptism. We welcome our disabled worshipers who have brought their service dogs with them. We welcome Muslims, Jews, politicians, and sinners like us. We extend a special welcome to those who are over 60 but not grown up yet, and to teenagers who are growing up too fast. We welcome soccer moms, NASCAR dads, starving artists, tree-huggers, latte-sippers, vegetarians, junk-food eaters. We welcome those who are in recovery or still addicted. We welcome you if you're having problems, or you're down in the dumps, or you don't like "organized religion;" we've been there too. If you blew all your offering money at the casino, you're welcome here. We offer a special welcome to those who think the earth is flat, who work hard, don't work, can't spell, or come because grandma is in town and wanted to go to church. We welcome those who are inked, pierced, or both. We offer a special welcome to those who could use a prayer right now, had religion shoved down your throat as a kid, or got lost in traffic and wound up here by mistake. We welcome tourists, seekers, doubters, bleeding hearts... and you!

Borrowed from the Toledo SDA Church

Clearlake Seventh-day Adventist Church



June 16, 2018

Our Church at Study

10am

God's Seal or the Beast's Mark?



Welcome
Lesson

Carol Lewis
Carol Lewis

Map

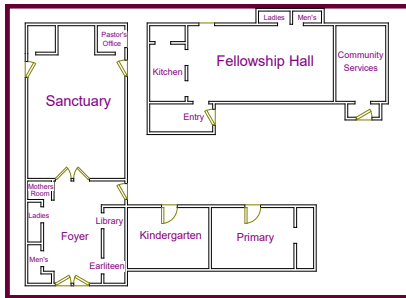

Church Calendar

Sabbath

6-23-18

10 am Sabbath School
S.S. Teacher: Daniel Lewis
10:45 am Worship Service
Sermon: Pastor Ted Calkins
Offering: Local Church Budget

8:39 pm Sabbath Ends

Sabbath

6-30-18

10 am Sabbath School
S.S. Teacher: Daniell Lewis
10:45 am Worship Service
Sermon: Dennis Blum
Offering: Impact Pacific Union

8:39 pm Sabbath Ends

Our Church at Worship

11:15 AM

Welcome/Announcements Elicia Kalua
Opening Song No. 412
*Invocation: Bill Hodgkin
Worship in Giving Local Church Budget Elicia Kalua
Children's Story Bill Hodgkin
Call to Worship Carol Lewis
Luke 7:36-39 & 50
*Morning Prayer Carol Lewis
*Prayer Response:

*"I Love you, Lord, and I lift my voice
To worship You, Oh, my soul, Rejoice
Take joy my King, in what You hear.*

Let it be a sweet, sweet sound, in Your ear"

Worship in Music Women's Quartet
Today's Message: Bill Hodgkin
"From 'As-Is' to Value Beyond Calculation"
Music Meditation
Benediction Bill Hodgkin
Postlude:

Piano/Organ: Karla Vliet

Public Address: Mark Gotham

* Please wait during this time to enter the Sanctuary

Not I, but Christ in me, the Hope of Glory...

For Your Information:

Visitors: We thank God for this time together!

Welcome to our Worship Service today as we share with you in singing, prayer and worship of our Gracious Lord and Savior, Jesus.

Welcome each and every one. We are thankful that you have chosen to worship here today.

Loose Plate Offering: Loose plate offerings go to the project identified in the bulletin. Please place specifically targeted offerings in an offering envelope and label it appropriately

Bulletin: The deadline for the bulletin information is 12 Noon on Wednesdays. Please send information to Carol Blum at cblum39@gmail.com or call 367-3693.

Wednesday, 6:00 PM our Prayer Meeting series continues as we work through "Steps to Personal Revival," and also a significant time in prayer.

Wednesday June 20. Prayer Meeting: The Cross and the Holy Spirit.

Live in such a way that those who know you but don't know God will come to know God because they know you.

School News

- **E-Script** for Clearlake SDA Christian School
<https://secure.escrip.com/jsp/supporter/registration/step1.jsp>
- Turn in your labels in the foyer and go to the website
Labels ~ <http://www.labelsforeducation.com/>
Contact person is Edna Day—707-350-4918
- Please continue to lift up in prayers our school, our students, and the families represented during this school year.

Sunset Tonight 8:38

Ted Calkins, Pastor	994-4776
Ted.calkins@nccsda.com	
Http://clearlakesdachurch.com	
Head Elders:	
A. Dennis Blum	367-4632
B. Bill Hodgkin	994-9895
Church Clerk: Kathren Agular	349-0708
Bulletin Editor: Carol Blum	367-3693
Head Deacon & Audio Visual: Mark Gotham	349-1498
Treasurer: Carol Blum	367-3693
Sabbath School Superintendent: Bill Hodgkin	994-9895
School Principal: Dolly Milholland	965-0951
Community Services:	

Church Treasurer's Address
P.O. Box 4071
Clearlake, CA 95422

Church Mailing Address
P.O. Box 3888
Clearlake, CA 95422