

## Welcome

We extend a special welcome to those who are single, married, divorced, gay, filthy rich, dirt poor, y no habla ingles. We extend a special welcome to those who are crying newborns, skinny as a rail, or could afford to lose a few pounds. We welcome you if you sing like Andrea Bocelli or can't carry a note in a bucket. You're welcome here if you're just browsing, just woke up, or just got out of jail. We don't care if you're more Catholic than the Pope, or haven't been in church since little Joey's baptism. We welcome our disabled worshipers who have brought their service dogs with them. We welcome Muslims, Jews, politicians, and sinners like us. We extend a special welcome to those who are over 60 but not grown up yet, and to teenagers who are growing up too fast. We welcome soccer moms, NASCAR dads, starving artists, tree-huggers, latte-sippers, vegetarians, junk-food eaters. We welcome those who are in recovery or still addicted. We welcome you if you're having problems, or you're down in the dumps, or you don't like "organized religion;" we've been there too. If you blew all your offering money at the casino, you're welcome here. We offer a special welcome to those who think the earth is flat, who work hard, don't work, can't spell, or come because grandma is in town and wanted to go to church. We welcome those who are inked, pierced, or both. We offer a special welcome to those who could use a prayer right now, had religion shoved down your throat as a kid, or got lost in traffic and wound up here by mistake. We welcome tourists, seekers, doubters, bleeding hearts... and you!

Borrowed from the Toledo SDA Church

## Clearlake Seventh-day Adventist Church



February 16, 2019

### Our Church at Study

10 AM

### The Sealed People of God

Welcome	Carol Lewis
Lesson	Carol Lewis

### Our Church at Worship

Welcome/Announcements	Elicia Kalua
Opening Song	No 322
*Invocation:	Dennis Blum
Worship in Giving	Elicia Kalua
Local Church Budget	
Children's Story	Dennis Blum
Call to Worship	Carol Lewis
*Morning Prayer	Carol Lewis
*Prayer Response:	

*Matt. 22:37-40; Romans 13:10; I John 4:8*

*"I Love you, Lord, and I lift my voice  
To worship You, Oh, my soul, Rejoice  
Take joy my King, in what You hear.  
Let it be a sweet, sweet sound, in Your ear"*

Worship in Music	John Klier
Today's Message:	Dennis Blum
Closing Song	No. 554
Benediction	Dennis Blum
Postlude:	

*"If A=B and B=C therefore, A=C"*

## Map

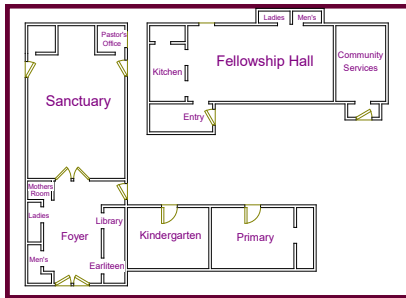

## Church Calendar

### Sabbath 2-23-19

10 am	Sabbath School
S.S. Teacher:	Dennis Blum
11:15 am	Worship Service
Sermon:	Pastor Ted Calkins
Offering:	Local Church Budget

5:55pm Sabbath Ends

### Sabbath 3-2-19

10 am	Sabbath School
S.S. Teacher:	Robert Davis
11:15 am	Worship Service
Sermon:	Bill Hodgkin
Offering	Local Church Budget

6:02 pm Sabbath Ends

Piano/Organ: Susan Jen

Public Address: Mark Gotham

\* Please wait during this time to enter the Sanctuary

Not I, but Christ in me, the Hope of Glory...

## For Your Information:

**Visitors:** We thank God for this time together!

Welcome to our Worship Service today as we share with you in singing, prayer and worship of our Gracious Lord and Savior, **Jesus**.

**Welcome** each and every one. We are thankful that you have chosen to worship here today.

**Loose Plate Offering:** Loose plate offerings go to the project identified in the bulletin. Please place specifically targeted offerings in an offering envelope and label it appropriately

**Bulletin:** The deadline for the bulletin information is 12 Noon on Wednesdays. Please send information to Carol Blum at [cblum39@gmail.com](mailto:cblum39@gmail.com) or call 367-3693.

**Every Wednesday Evening** at 6 pm **Prayer Meeting** -40 Days-Prayers and Devotions Reflecting on the Cross of Christ by Dennis Smith.

**PUC Visual Arts Faculty Show** (Feb. 16) Opening Reception 7:00 p.m., Rasmussen Art Gallery. Runs through March 17. Info: 707-965-7362.

**Math/Science Workshop** (Feb. 24) Annual college math and science experience for academy students. Registration required. For information, email [biology@puc.edu](mailto:biology@puc.edu).

**Heubach Lectureship Series** (Feb. 28) 7 p.m., Pacific Union College. Dr. Jon Paulin, dean of the School of Religion at Loma Linda University, will be the featured speaker. Admission is free. Info: [pr@puc.edu](mailto:pr@puc.edu)

**2019 Lecture of the Percy & John Christian Civil Rights Conference Center** (March 7) 4 p.m., Paulin Hall, Pacific Union College. Historian Dr. Ronald D. Graybill presents the annual lecture. Info: 707-965-7500 or [alumni@puc.edu](mailto:alumni@puc.edu).

**Come join us for Choir practice**, 5PM Wednesday evenings. One hour before Prayer Meetings.

**Sabbath February 23, 11:15 AM** will be our annual visit from the Sacramento Central Choir, with a presentation of a special mini-concert. They will also join us for a combined Fellowship Dinner after our worship service.

**Wednesday 5 pm: Choir Practice; 6 pm: Prayer Meeting; 7 pm: Church Board Meeting.**

**Hans Hielscher presents a recital on the Rieger organ** Sabbath afternoon, February 16, at 4:00 pm in the PUC Church Sanctuary. Hielscher has been organist at the Marktkirche in Wiesbaden, Germany, since 1979 and has presented more than 3500 organ recitals around the globe. Don't miss this special concert on the newly-refurbished Rieger organ. A free-will offering will be collected.

Live in such a way that those who know you but don't know God will come to know God because they know you.

### Sin is a Broken Relationship with God

#### Jeremiah 2:9

If  $A=B$  and  $B=C$  therefore  $A=C$

Jesus [Matt. 22:37-40] and Paul

[Rom. 13:10] said **The Law is**

**Love.**

John [I John 4:8,16] said **God is**

**Love.**

Therefore the Law [A] equals God

[B]

**The Law is a Transcript of God's Character**

### School News

- **E-Script** for Clearlake SDA Christian School  
<https://secure.escrip.com/jsp/supporter/registration/step1.jsp>
- Turn in your labels in the foyer and go to the website  
Labels ~ <http://www.labelsforeducation.com/>  
Contact person is Edna Day—707-350-4918
- Please continue to lift up in prayers our school, our students, and the families represented during this school year.

Sunset Tonight 5:47 pm

Ted Calkins, Pastor	994-4776
Ted.calkins@nccsda.com	
Http://clearlakesdachurch.com	
Head Elders:	
A. Dennis Blum	367-4632
B. Daniel Lewis	533-9177
Church Clerk: Katheren Agular	349-0708
Bulletin Editor: Carol Blum	367-3693
Head Deacon & Audio Visual: Mark Gotham	349-1498
Treasurer: Barbara Dryden	481-0733
School Principal: Dolly Milholland	965-0951
Community Services:	

Church Treasurer's Address  
P.O. Box 4071  
Clearlake, CA 95422

Church Mailing Address  
P.O. Box 3888  
Clearlake, CA 95422