

# Welcome

We extend a special welcome to those who are single, married, divorced, gay, filthy rich, dirt poor, y no habla ingles. We extend a special welcome to those who are crying newborns, skinny as a rail, or could afford to lose a few pounds. We welcome you if you sing like Andrea Bocelli or can't carry a note in a bucket. You're welcome here if you're just browsing, just woke up, or just got out of jail. We don't care if you're more Catholic than the Pope, or haven't been in church since little Joey's baptism. We welcome our disabled worshipers who have brought their service dogs with them. We welcome Muslims, Jews, politicians, and sinners like us. We extend a special welcome to those who are over 60 but not grown up yet, and to teenagers who are growing up too fast. We welcome soccer moms, NASCAR dads, starving artists, tree-huggers, latte-sippers, vegetarians, junk-food eaters. We welcome those who are in recovery or still addicted. We welcome you if you're having problems, or you're down in the dumps, or you don't like "organized religion;" we've been there too. If you blew all your offering money at the casino, you're welcome here. We offer a special welcome to those who think the earth is flat, who work hard, don't work, can't spell, or come because grandma is in town and wanted to go to church. We welcome those who are inked, pierced, or both. We offer a special welcome to those who could use a prayer right now, had religion shoved down your throat as a kid, or got lost in traffic and wound up here by mistake. We welcome tourists, seekers, doubters, bleeding hearts... and you!

Borrowed from the Toledo SDA Church

# Clearlake Seventh-day Adventist Church



November 3, 2018

## Our Church at Study

10 AM

## The Experience of Unity in the Early Church

Welcome  
Lesson

Susan Jen  
Susan Jen

## Our Church at Worship

11:15 AM

|   |   |
|---|---|
| Welcome/Announcements   | Dennis Blum   |
| Opening Song  | No. 341   |
| *Invocation:  | Daniel Lewis  |
| Worship in Giving   | Dennis Blum   |
| Local Church Budget   |   |
| Children's Story  | Daniel Lewis  |
| Call to Worship <i>2 Corinthians 12: 9; 1 Corinthians 15:10</i> | Robert Davis  |
| *Morning Prayer   | Robert Davis  |
| *Prayer Response:   |   |
|   | <i>"I Love you, Lord, and I lift my voice<br/>To worship You, Oh, my soul, Rejoice<br/>Take joy my King, in what You bear.<br/>Let it be a sweet, sweet sound, in Your ear"</i> |
| Worship in Music  | Joe Williams  |
| Today's Message:  | Daniel Lewis  |
|   | <i>" Alluring Grace; God's Gospel Glory"</i>  |
| Hymn of Response  | No. 109   |
| Benediction   | Daniel Lewis  |
| Postlude:   |   |

# Map

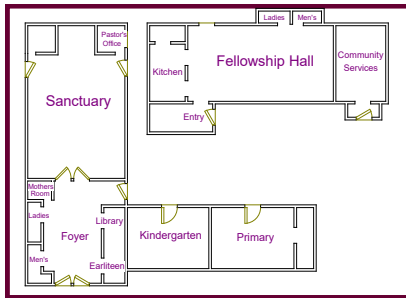

# Church Calendar

## Sabbath

11-10-18

|               |                               |
|---------------|-------------------------------|
| 10 am         | Sabbath School                |
| S.S. Teacher: | Dennis Blum                   |
| 11:15 am      | Worship Service               |
| Sermon:       | Pastor Calkins                |
| Offering:     | Annual Sacrafice/World Budget |

## 5:00 pm Sabbath Ends

## Sabbath

11-17-18

|               |                     |
|---------------|---------------------|
| 10 am         | Sabbath School      |
| S.S. Teacher: | Joe Williams        |
| 11:15 am      | Worship Service     |
| Sermon:       | Dennis Blum         |
| Offering      | Local Church Budget |

## 5:00 pm Sabbath Ends

Piano/Organ: Susan Jen

Public Address: Mark Gotham

\* Please wait during this time to enter the Sanctuary

Not I, but Christ in me, the Hope of Glory...

## For Your Information:

**Visitors:** We thank God for this time together!

Welcome to our Worship Service today as we share with you in singing, prayer and worship of our Gracious Lord and Savior, Jesus.

Welcome each and every one. We are thankful that you have chosen to worship here today.

**Loose Plate Offering:** Loose plate offerings go to the project identified in the bulletin. Please place specifically targeted offerings in an offering envelope and label it appropriately

**Bulletin:** The deadline for the bulletin information is 12 Noon on Wednesdays. Please send information to Carol Blum at [cblum39@gmail.com](mailto:cblum39@gmail.com) or call 367-3693.

**Every Wednesday Evening** at 6 pm **Prayer Meeting** -40 Days-Prayers and Devotions Reflecting on the Cross of Christ by Dennis Smith.

**Christian Edition concert Sabbath, November 10**, 6:30 pm at the PUC Church. You are invited to join in worship as this internationally known and acclaimed men's chorus from Southern California presents a program of classic Christian hymns and selected contemporary sacred music. Bring your friends to this outstanding event. Free admission.

**Time changes tonight.** Change your clocks back one hour. You get an extra hour sleep tonight.

**Second Reading for Nominating Committee:**  
Robert Davis, Lesley Ford, Mark Gotham, Bill Hodgkin, Rachael Hutchinson, Elicia Kalua, Geraldine Willams.

**Membership Transfer: Second Reading:**  
Connie Coatney to Join the Clearlake Church from Redwood Valley.

**The Wheel of Faith** series has been canceled.

**Next Sabbath** will be our regular bi-monthly Fellowship Dinner, a baptism, and a Communion Service.

**NAPA VALLEY ADVENTIST RETIREES** are invited to meet Monday, November 19, at Saint Helena Seventh-day Adventist Church Fireside Room at 1777 Main St in St. Helena. Social hour begins at 5:30 p.m. and Dinner at 6:00 p.m. The cost of dinner is \$12 per person payable at the door. The program will be presented by Myrna David, Director of Upper Valley Village, regarding seniors helping seniors. To place a reservation (*required*) or for additional information please contact Suzie Ermshar at 707-965-1116 or [sermshar@puc.edu](mailto:sermshar@puc.edu). **Reservation cut-off date is November 14.**

Wednesday, November 7, at 7:00 PM Nominating Committee.

*Live in such a way that those who know you but don't know God will come to know God because they know you.*

---

## School News

- **E-Script** for Clearlake SDA Christian School  
<https://secure.escrip.com/jsp/supporter/registration/step1.jsp>
- Turn in your labels in the foyer and go to the website  
Labels ~ <http://www.labelsforeducation.com/>  
Contact person is Edna Day—707-350-4918
- Please continue to lift up in prayers our school, our students, and the families represented during this school year.

Sunset Tonight 6:15 pm

---

|   |          |
|---|----------|
| Ted Calkins, Pastor   | 994-4776 |
| <a href="mailto:Ted.calkins@nccsda.com">Ted.calkins@nccsda.com</a>        |          |
| <a href="http://clearlakesdachurch.com">Http://clearlakesdachurch.com</a> |          |
| Head Elders:  |          |
| A. Dennis Blum  | 367-4632 |
| B. Bill Hodgkin   | 994-9895 |
| Church Clerk: Kathren Agular  | 349-0708 |
| Bulletin Editor: Carol Blum   | 367-3693 |
| Head Deacon & Audio Visual: Mark Gotham                                   | 349-1498 |
| Treasurer: Carol Blum   | 367-3693 |
| Sabbath School Superintendent: Bill Hodgkin                               | 994-9895 |
| School Principal: Dolly Milholland  | 965-0951 |
| Community Services:   |          |

---

Church Treasurer's Address  
P.O. Box 4071  
Clearlake, CA 95422

Church Mailing Address  
P.O. Box 3888  
Clearlake, CA 95422