

# Studying Together

9:30 AM. – 10:40 AM

*Please join us as we study the Bible together.  
Children's classes meet in the south wing of the church.  
You are invited to attend any of the studies.*

- **A** – Cradle Roll Room (ages 0-3)
- **B** – Kindergarten Room (ages 4-6)
- **C** – Primary Room (ages 7-9)
- **D** – Junior/Early Teen Room (ages 10-14)
- **E** – Youth Room (High School)
- **F** – Elder's Room (College/Young Adult)
- **G** – Sanctuary (Adult): Taught by Johnny Mata, studying "The Book of Exodus"
- **H** – Mother's Training Room (Adult): Taught by Tony Rodriguez, studying the Adult Sabbath School Lesson
- **I** – Fellowship Hall (Adult): Taught by David Pierson; Bob Christenson; Jim Wilson; Steve Williams, studying the book of Revelation

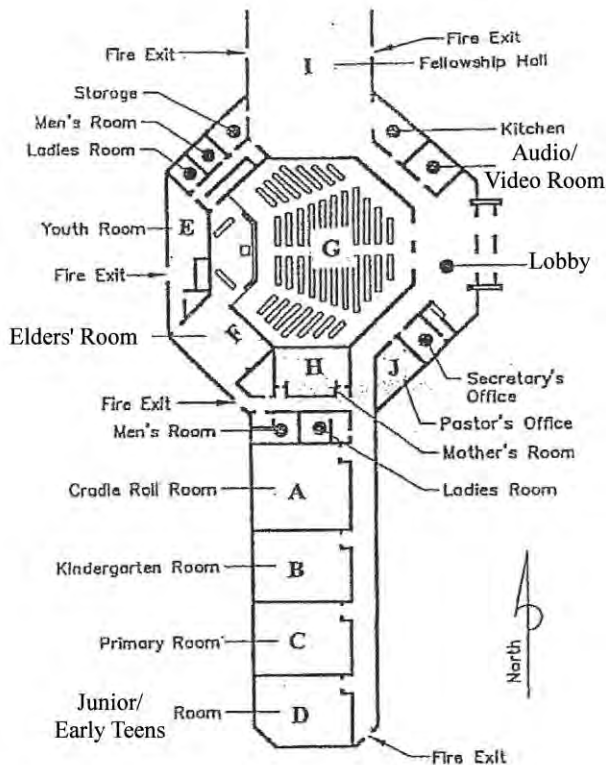

# Church Staff

Office Hours: *please call for office hours*

**Pastor** Bill Kasper  
**Head Elder** Johnny Mata  
**Head Deacon** Brian Geery  
**Head Deaconess** Ruth Troyer  
**Treasurer** Sara Bernard  
**Church Clerk** Ann Richards  
**Church Assistant** Tonya Trujillo  
**Church Office** 836-1845  
**Church e-mail** [abqcentral@gmail.com](mailto:abqcentral@gmail.com)  
**Church website** [abqcentral.org](http://abqcentral.org)

## Duties for Sabbath, 12/08

**Elders:** Peter Pribis, Bob Christenson  
**Lead Deaconess:** Aimee Pribisova  
**Deaconesses:** Amelia Geery, Marilyn Christenson, Irene McKenzie, Micah Garcia  
**Greeters:** Jane Wical, Len LaClair  
**Children's Story:** Ray Van Why  
**Soundboard:** Abel Flores

## Duties for Sabbath, 12/15

**Elders:** Joanna Herr, Ed Simonson  
**Lead Deacon:** David Driscoll  
**Deacons:** Bill Hallock, Tony Rodriguez, Skye Crossan, Jonathon Kasper  
**Greeters:** Marilyn Christenson, Rosie Wilson  
**Children's Story:** Ann Richards  
**Soundboard:** Peter Pribis

**January 5- Potluck- Team A:** Brian & Tricia Geery, Len & Sharon LaClair, Peter & Natasha Pribis, Bob & Marilyn Christenson

**SUNSET TODAY: 4:54 SUNSET NEXT WEEK: 4:56**

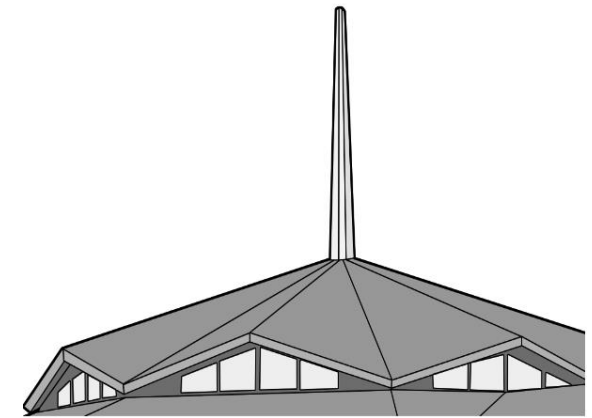

# ALBUQUERQUE CENTRAL

SEVENTH-DAY ADVENTIST  
CHURCH



2201 Estancia NW  
Albuquerque, NM 87120

(505) 836-1845

[abqcentral@gmail.com](mailto:abqcentral@gmail.com)

Website: [abqcentral.org](http://abqcentral.org)



Like us on FaceBook!

*In glorifying Christ, we consecrate our lives  
in order to reach our community for the  
imminent return of Jesus.*

# Worshipping Together

December 8, 2018

10:50 AM

## We Gather

In Meditation

Prelude

Call to Worship

Youth Praise Team

Appreciation for His/your presence

## We Praise

With Songs of Praise

Youth Praise Team

With Matters of the Heart

Welcome / Prayer Request

Peter Pribis

Scripture

James 5:17,18

Prayer

(Please remain kneeling for response)

In Tithes and Offerings

Bob Christenson

Offertory

## We Honor

Children's Story

Ray Van Why

Gift of Music

Amanda & Tricia Geery

Sermon

Pastor Bill Kasper

"The Prophet Elijah"

## We Respond

Closing Hymn

#86

"How Great Thou Art"

Blessing

Pastor Bill Kasper

\* \* \* \*

Organist

Carolyn Swartz

Pianist

Amanda Geery

*If you'd like special prayer, please join us at the right side of the platform after today's service*

## Welcome!

We are glad you came to worship with us today. We hope your time with us deepens your understanding of God and encourages you to pursue Him in your daily life.

## For Your Information

**Community Outreach Program:** We need nonperishable food and warm clothing donations. You can drop them off each Sabbath, in the box that is in the church lobby, through the end of the year.

**Support the Pathfinders:** Central Pathfinders are asking for prayers and monetary donations to help rebuild their club. To donate to the Pathfinders, use a tithe envelope and write Pathfinders on it. Please pray for our young pathfinders that they may know God deeper and carry his message to the world. Thank you.

**Assembling Care Packages:** Everyone is invited to join us Saturday **December 8th** at 4:00pm in the fellowship hall as we put together care packages and go Christmas caroling to homes near the church. Individual prepackaged snack donations welcome.

**Ten Days of Prayer:** Our next opportunity for group prayer is **January 9-19**. Let's all join in prayer as we begin a new year.

**Crestview Fundraiser:** Collecting used computer ink cartridges. Please give your empty ink cartridges to any Crestview student or staff.

**"A Night in Bethlehem"** Experience Bethlehem during the census; visit shopkeepers in the marketplace and learn about their trades. Make special keepsakes and sample breads, sweets, cheeses and other authentic foods on your journey through Bethlehem. Follow the innkeeper to the stable and meet Mary, Joseph and baby Jesus. Held at SVCS gym, 24 Academy Drive, Corrales.

**December 8<sup>th</sup>**, so you can go after church service, they will remain open till 3PM.

**Christmas Around the World at Crestview SDA Academy:** Please join us for our Christmas Around the World program on **December 11**, at 6:30 p.m. located at 6000 Ouray Rd. NW, Albuquerque, NM 87120. Enjoy listening, learning, and sampling the traditional foods of China, Switzerland, Peru, the Philippines, and England.

**Bulletin Announcements** must be emailed to church by **noon on Wednesday**. Please keep message brief as possible. Posting will be based on available space.

## Offering Emphasis

**Today's Offering** Adventist Community Services  
**Next Sabbath** Local Church Budget

## Combined Budget

	November	YTD
<b>Budgeted to Date</b>	\$ 10,670.40	\$53,352.00
<b>Received to Date</b>	\$ 11,077.13	\$68,638.98
<b>Balance</b>	\$ 406.73	\$15,286.98

**Treasurer Tip:** Please take some Tithe and Offering envelopes home. That way you can fill them out in the comfort of your own home.

## Calendar of Events

Dec. 8	SVA "Night in Bethlehem"	till 3PM
	Assembling Care Packages	4PM
Dec. 11	CCA Christmas Around the World	6:30 PM
Dec. 12	Bible Study	11AM & 7PM
	Ladies Prayer Grp	6PM
Dec. 15	Pathfinders	following service
	Central Christmas Social	6PM
Dec. 19	Bible Study	11AM & 7PM
	Ladies Prayer Grp	6PM

**Assembling Care Packages  
And Christmas Caroling  
Tonight, Dec. 8, 4:00 PM  
Prepackaged snack donations welcome!**



# NEXT CHURCH BOARD MEETING:



**Monday, Dec. 10<sup>th</sup> @ 7:00 PM**



*Come celebrate at Central's*

*Christmas Social*

*December 15, 6:00 PM*





Join the global prayer chain!  
7 am 7 pm 7 days a week

The image features a background with a soft, ethereal glow of light rays in shades of teal and gold. In the center, there are several overlapping, semi-transparent white rectangular shapes that resemble sticky notes or speech bubbles. The text 'PRAYER MEETING' is prominently displayed in the largest, most central white shape. The word 'PRAYER' is in a bold, dark blue, sans-serif font, while 'MEETING' is in a dark blue, serif font with a slight slant. Below this, a solid dark blue horizontal bar contains the text 'WEDNESDAYS' and '11 AM AND 7 PM' in a clean, white, sans-serif font.

**PRAYER**  
*MEETING*

**WEDNESDAYS**  
**11 AM AND 7 PM**



**Wednesdays**

**6:00 pm**

**ladies  
prayer  
group**

**Cradle Roll Room**





**Crestview needs major renovations.  
Consider donating to our school!  
Visit [csdaa.org](http://csdaa.org)**





**Crestview SDA Academy  
8<sup>th</sup> Graders are collecting  
empty ink cartridges!**